



Skool Kat, Manually Propelled Tricycle. Instructions for Use.

**UK
CA**

C E

MD



Phone Number
+44 1452 616 900



Our Website
www.tomcatuk.org

marketing@tomcatuk.org



Thank you for choosing a Tomcat™ product. We wish you many years of fun, therapy and usefulness from it.

Your Tomcat trike is a class 1 medical device it's intended purpose is to provide alleviation or compensation for a disability. When used as part of a regular exercise regime, cycling can greatly benefit the user's strength, mobility and general health and wellbeing. This user information is intended to help you get the best possible benefit from the product.

Your tricycle may be provided with special adaptations to compensate for certain issues such as reduced mobility, and when independent use of the tricycle is not possible or safe, your tricycle may be provided with special adaptations that enable a user to cycle with the assistance and supervision of a pedestrian carer.



To stay safe and get the best from your product, please read these instructions carefully.



Warning



Observe your country's highway regulation at all times.



Always wear a helmet and suitable protective clothing.



Use all safety devices provided at all times.



Do not carry passengers or allow others to ride on the rear axle or basket.



Use the park brake when mounting/dismounting or when leaving the vehicle unsupervised.



On supervised trikes, i.e. Carer Controlled trikes, do not leave the rider unattended, even if the park brake is applied.



Do not ride over kerbs (except "drop kerbs") or other hazards that may destabilise the vehicle or damage the carer assistance components or linkages.



Do not use off-road, on steep inclines, heavy cambers or sloping or uneven ground.



Any serious incident that occurs in relation to the device should be reported to the manufacturer and the competent authority of the Member State in which the user is established

Tricycle General Care and Safety.

Before Use:

- Ensure lights, reflectors, flags and warning devices are in good working order.
- Check tyre condition and maintain correct tyre pressure as printed on the tyre wall.
- Test all braking and steering functions including Carer Braking.
- Ensure all removable components (wheels, seat, divisible frame mechanisms, etc) are secure, correctly assembled in accordance with user manual instructions, interlocked where appropriate, and in good working order.

When in Use:

- Always use all safety devices provided.
- Observe the national and local laws on cycling.
- Carry a means of communication for emergency use.
- Use a secure cycle lock when leaving the tricycle unattended.

After Use:

- Clean and dry the tricycle before storing.
- Store in a dry location away from Ultraviolet (UV) light.
- Charge Battery Pack (never leave the battery in a discharged state)
- Service the trike in accordance with the user handbook or after prolonged storage.

Regularly:

- Check the tyre pressure (printed on tyre wall) and tyre condition. Replace any tyres that are worn, bulging, cracked or perished.
- Check that the brakes function effectively, show no signs of wire corrosion, and are appropriately adjusted to suit the rider. For further information, refer to the manual (available online).
- Check safety devices, e.g. reflectors, lights, bell, luminous surfaces are in good condition and unobstructed.

Tricycle General Care and Safety.

Annually and before winter storage

- Visually check the chain drive lubrication through the inspection port. If the chain looks dry or corroded, lubricate well with cycle grease or chain lubricant.

Note 1 with proper care, the chain drive is warranted maintenance free for five years from the date of purchase (original purchaser only). Proper care includes protection from tampering, misuse, unauthorised modification, or repair; corrosive conditions such as damp, salty, wet or humid storage; abrasive conditions such as sand, dirt or dust; or long-term exposure to the elements.

Note 2 If pressure washing, do not spray near or through the inspection port. Always lubricate the chain after pressure washing.

Tricycle General Postural Guidance.

- With one pedal at its lowest position, adjust the saddle height until the extended leg is slightly bent at the knee.
- If the feature is fitted, adjust the seat forward or backwards (3 positions) until a comfortable seating/pedaling position is found.
- Adjust the backrest (if fitted) to allow the buttocks to sit on the widest part of the saddle.
- Adjust the height of the handlebars. When correct the forearms will be horizontal.
- Adjust the “reach” of the handlebars. When correct, the spine will be vertical, and the sightline will be horizontal.
- Adjust the gap between lateral supports (if fitted) to closely match the body and its clothing. Avoid large gaps.
- Adjust the accessories, (footshoes, harness, leg calipers, gloves, headrest, etc, in accordance with the advice of your physiotherapist or healthcare professional.

Adjustment of the Tricycles Constructional Features (Where Fitted).



Note! Unless stated otherwise, refitting or locking is a reversal of removing or unlocking)

Swivelling Saddle

- Pull the black knob (beneath saddle) down.
- Rotate the saddle to left or right then release the knob. The saddle locks automatically when full rotation is reached.

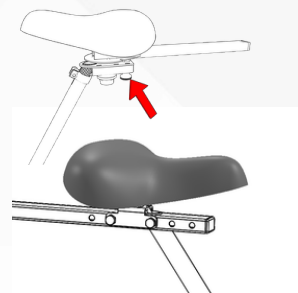

Reach Adjustable Seat.

- Remove the securing bolts (2)
- Reposition the saddle and refit the securing bolts.
- Tighten till seat is firm but do not over-tighten.

Changing between “Fixed” and “Free Wheeling” Drive (Dual Drive™)

- To engage Fixed Drive, turn plunger (1) till it drops into the slot. Turn the pedals or push the trike till an audible “click” is heard.
- To engage Free-Wheel drive, pull plunger out of slot and rotate a quarter of a turn.

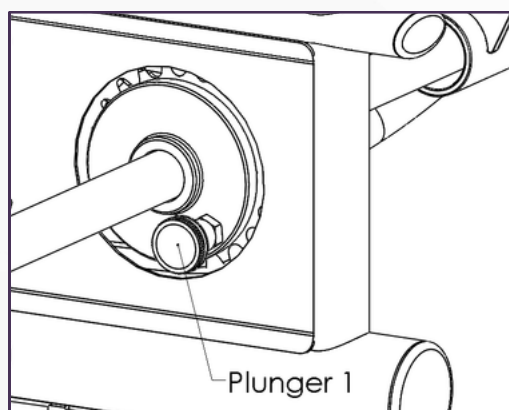

Tricycle Special Features Adjustment (Where Fitted)



Note! Unless stated otherwise, refitting or locking is a reversal of removing or unlocking)

Setting up the "Push Handle" Feature.

- Engage the plunger (1) with the slot of the Cam Plate (2)
- Rotate the Crank Plate (3) till the slot in the crank plate (3) (2 choices), aligns with Bump Bar (4)
- Slide Bump bar (4) fully into engagement with the slot in Crank Plate (3)
- Tighten bolts (5) to secure Bump Bar (4)
- Fit the Push Handle (6) to the Control Socket (7)
- Tighten screw (8) firmly with the Control Handle in line with the trike frame but do not overtighten.

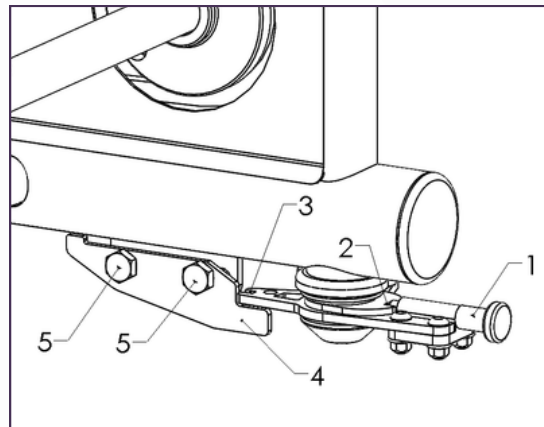

Note1. When choosing the slot in the Crank Plate (4), align the plunger with the axle on trikes with a basket. Align the plunger with the frame on trikes without a basket. (Shown)

Note2. Disengage Plunger (1) to fold the Control Handle into the frame (for storage or transport) or to use the Control Handle "unlocked".

Tricycle Special Features Adjustment (Where Fitted)



Note! Unless stated otherwise, refitting or locking is a reversal of removing or unlocking)

Setting up and aligning the “Carer Control” Feature.

- Engage the plunger (1) with the slot of the Cam Plate (2)
- Rotate the Crank Plate (3) till the slot in the crank plate (3) (two choices), aligns with Bump Bar (4)
- Slide Bump bar (4) fully into engagement with the slot in Crank Plate (3) to lock the steering mechanism in “mid” position.
- Align the Control Handle (6) with the frame and tighten screw (8) firmly but do not overtighten.
- Slacken Bolt 9 to raise or lower the handle. Tighten firmly but do not overtighten.
- Slacken bolts (5) and retract the Bump Bar (4) clear of the Crank Plate (3) Retighten bolts.

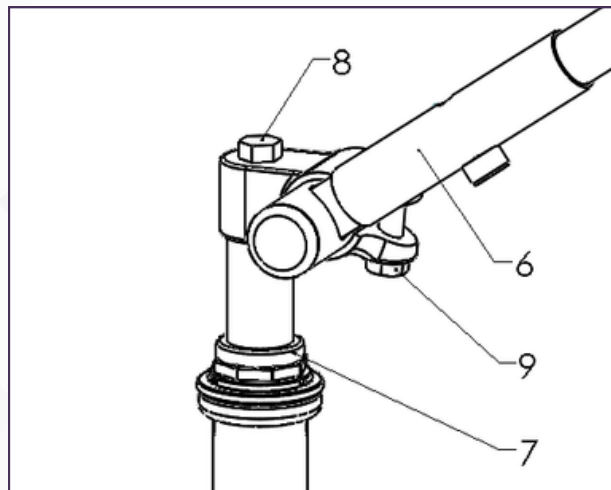

Note1. When choosing the slot in the Crank Plate (4), align the plunger with the axle on trikes with a basket. Align the plunger with the frame on trikes without a basket. To swap between options, refer to the service manual for instructions.

Note 2. To use the Control Handle in Carer Control™ (steering and braking) mode - engage the plunger 1.

To use the Control Handle in Carer Braking™ only, mode - disengage plunger 1.

Note3. To store or transport the trike - disengage the plunger (1).



Standard Cycle Components and Consumables/Accessories/Features

Note! Brake Levers, Gear change mechanisms, indicators, lights, reflectors, cycle helmets, pedals, cables, clamps, grips, saddles, pumps, repair kits etc. are standard and familiar cycle components, well known to the cycle industry and should be used in the manner intended by the manufacturer. If you are unsure on the use or maintenance of any standard cycle component; you should seek the advice of a cycle technician before use.



For further information on how to set up and use your trike safely please visit:
www.tomcatuk.org

IFU - Manual Trikes - Rev3 | April 2026

Disposal and Recycling

Tricycle: At the end of its service life, do not dispose of this vehicle in household waste. Hand it in at a municipal collection point or a specialised recycling centre. Always dispose of in accordance with local regulations.

Electronics (if applicable): This product is subject to the WEEE Directive. Electronic components and batteries must be disposed of separately. Remove the battery before disposal and take it to an authorised battery collection site.

Packaging: Protect the environment by sorting packaging materials for recycling according to your local municipal guidelines.

Add your notes here:



.....

.....

.....

.....

.....

.....

.....

.....

.....

.....

.....

.....

Warranty



Scan QR code to view full version of warranty.



Scan QR code to view video manual



tomcat



Tomcat SNI Ltd
Unit 13/7 The Gloucester Business Park
Hucclecote, Gloucester
GL3 4AA, UK
Tel +44(0)1452 616900
Email info@tomcatuk.org
Web www.tomcatuk.org



Advena Limited.
Tower Business Centre, 2nd Flr.,
Tower Street,
Swatar, BKR 4013
Malta.
Tel +356 2546 6689
Email info@advena.mt
Web www.advena.mt